

Product: RECEPTION

The eclectic *Grand More* tables range includes also the reception, which can be linear, L or C - shaped. Legs and profiles are 60 mm. The main feature is the L25 H90 cm ring (external H90 shelf) that encloses the H75 worktop, the cable tray and the top access.

On request, it can be also equipped with pedestal drawers. A shelf 20 cm depth can be positioned along the internal perimeter of the reception at 100 cm height. It is available in different dimensions and finishes.

TECHNICAL FEATURES

External tops: top are 22 mm thick, flush with structure, Laminate, Sablè lacquered, Steel lacquered, Veneer, Back-lacquered etched glass or Ceramic finish.

Internal tops: top are 22 mm thick, flush with structure Melamine, Sablè lacquered or Steel lacquered finish.

Vertical panel: structure panels available in Melamine, Sablè lacquered, Steel lacquered or Veneer finish.

Storage units (for "L" - "C" shaped desks): storage units structure made of panels available in Melamine, Sablè lacquered, Steel lacquered or Veneer finish.

Internal Shelf: positioned on the internal top side, available in back-lacquered etched glass or ceramic.

Legs: legs are in Luxury Metals or epoxy powder coated.

Top profiles: Aluminium profiles, connected to the legs, create a structure that is independent from the top. They are in Luxury metal or epoxy powder coated.

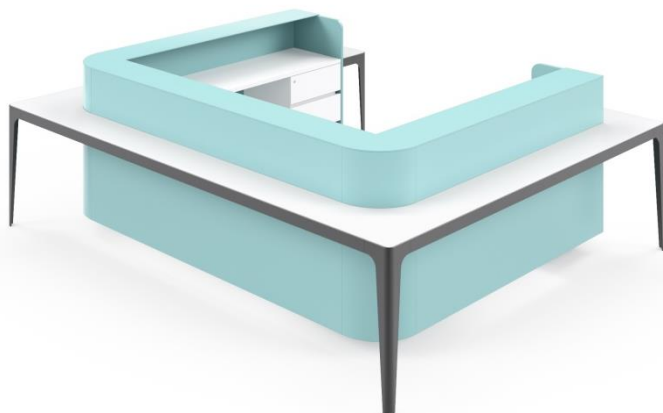

ELECTRIFICATION

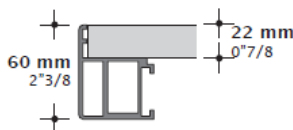
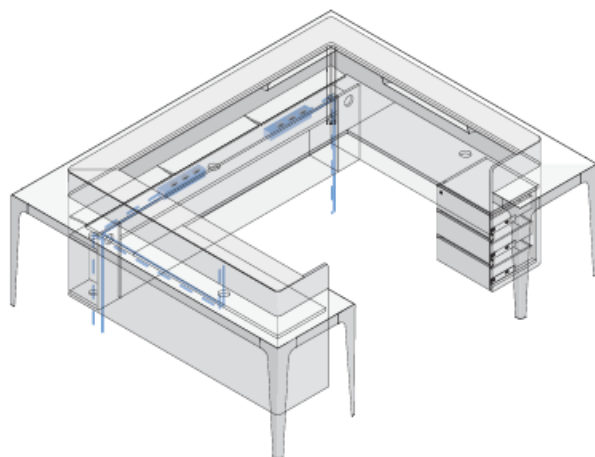

Laminate, sablè lacquered, Steel lacquered and Veneer tops.

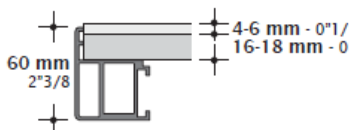

Ceramic tops.

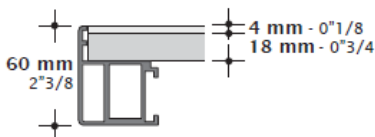

Back-lacquered etched glass tops.

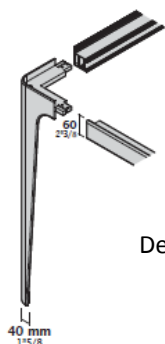

Detail: legs - top profiles connection.

FINISHES

External tops:

Laminate: White Snow, Oak, White Fenix.

Sablè lacquered, available in different sample collection colours.

Steel lacquered.

Veneer: Magnolia, Colour White Fir, Nuvola stained Oak, Natural Oak 2016, American Walnut, Eucalyptus, Wengè, Zebrano Brown, Ebano.

Back-lacquered etched glass: White, Silver, Titanio, Brown, Alfa Red.

Ceramic: Calacatta Soft, Calacatta Glossy, Statuario Soft, Statuario Glossy, Walks 1.0 White, Walks 1.0 Gray, Le Roche Ecrù, Ardoise Ecrù, Ardoise Noir, Nero Marquinia, Le Roche Grey, Industrial Ivory, Industrial Plomb.

Internal tops:

Melamine: UE White, Silver, Titanio, Delavè, Comfort, White Snow, Magnolia, Oak 2017, Eucalyptus, White Colour Fir.

Sablè lacquered, available in different sample collection colours.

Steel lacquered.

Vertical panel:

Melamine: see internal tops finishes.

Sablè lacquered, available in different sample collection colours.

Steel lacquered.

Veneer: see external tops finishes.

Storage units (for "L" - "C" shaped desks):

Melamine: see internal tops finishes.

Sablè lacquered, available in different sample collection colours.

Steel lacquered.

Veneer: see external tops finishes.

Shelf:

Back-lacquered etched glass: see external tops finishes.

Ceramic: see external tops finishes.

Legs:

Varnished metal: glossy or matt White Snow, glossy UE White, matt Titanio, matt Carbon Glacè, glossy Alfa Red.

Luxury Metal: Chromed, glossy Nickel Black, matt Bronze, matt Brass, matt Antique Brass, Pewter Quarz, Brunished Cobalt.

ACCESSORIES:

Monitor bracket.

Monitor holder.

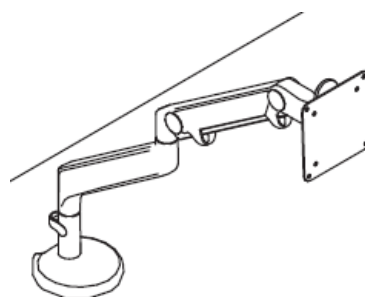
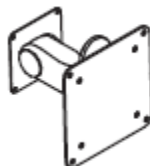

TYPES

Linear reception.

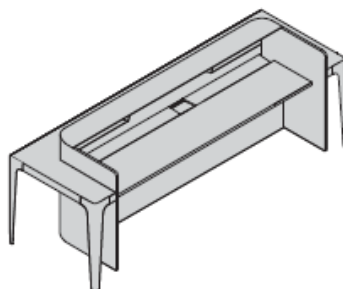

L-shaped reception.

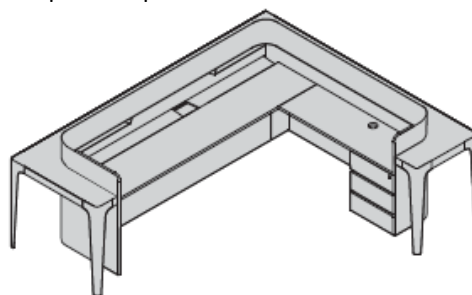

C-shaped reception.

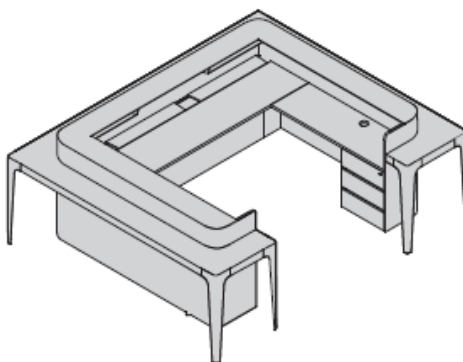

DIMENSIONS

Linear reception.

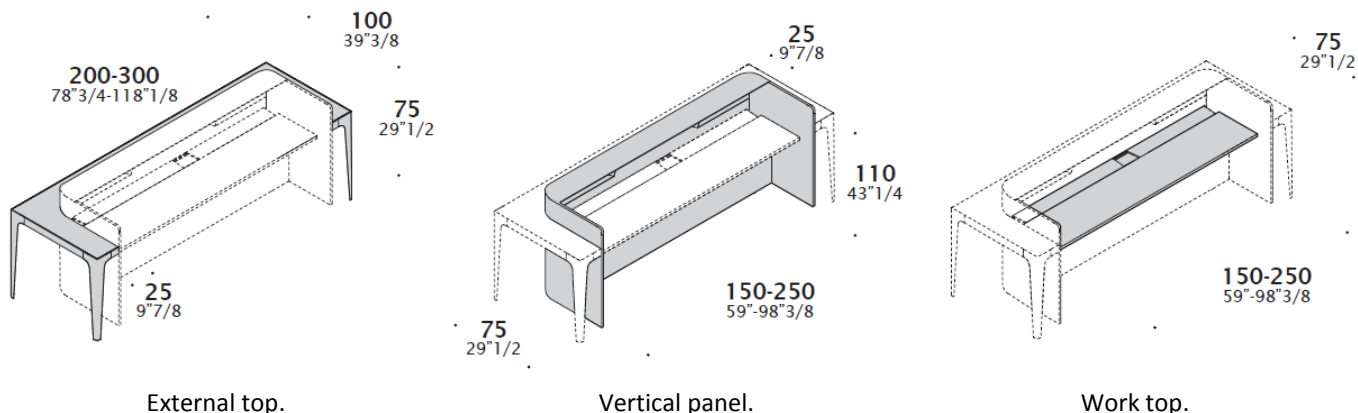

"L-shaped" reception.

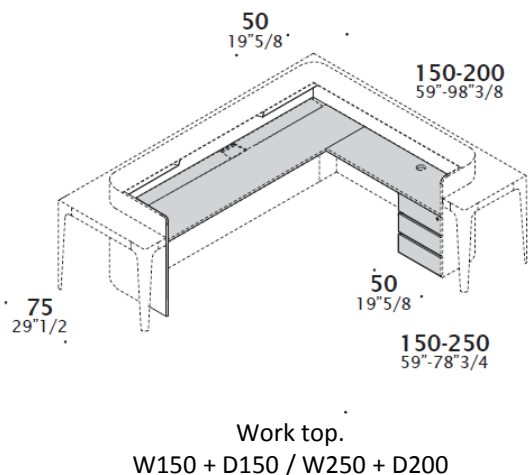
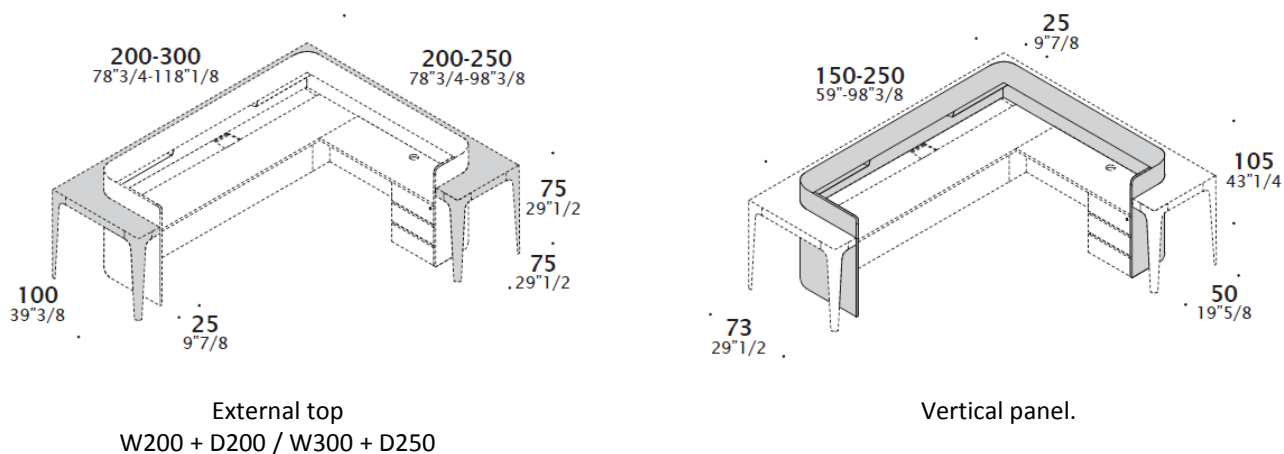

DIMENSIONS

“C-shaped” reception.

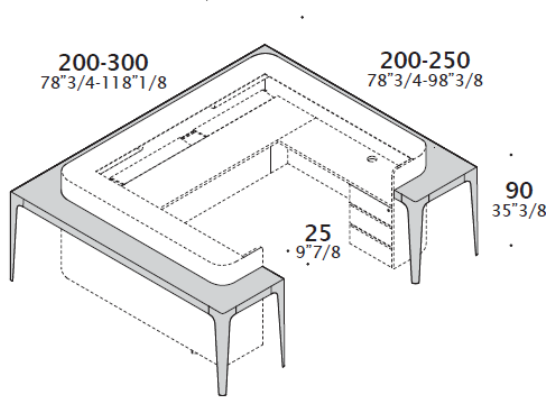

External top
W200 + D200 / W300 + D250

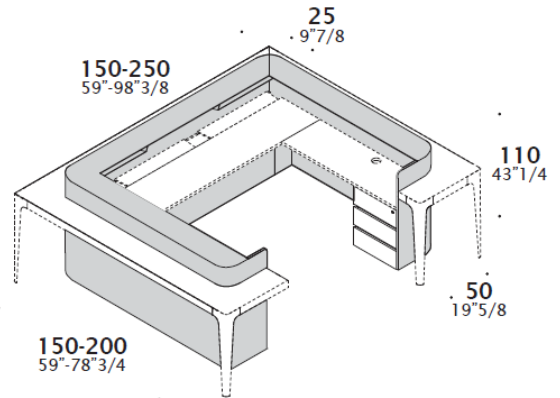

Vertical panel.
W150 + D150 / W250 + D200

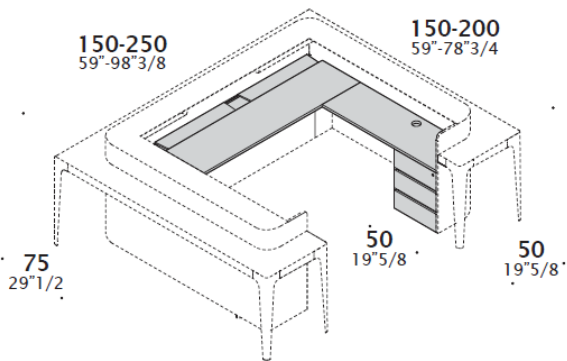

Work top.
W150 + D150 / W250 + D200